

# CLEANTECH

Leading laundry equipment



## LAUNDRY SYSTEMS

Technology of Japan 



*Strong - Economical - Durable*

# CLEANTECH

## WASHING MACHINES

**CLEANTECH** washing machines are developed not only to clean, but to extend linen life, reduce water usage and utility costs to maximize productivity. Our heavy-duty construction provides reliable operation and guarantees your washer-extractor will be in service for years to come, while our High G-Force extraction removes more water from each load, reducing energy cost, shortening drying times, thus increasing output.

### Features

- Use the most advanced technology controller, fast and easy data transfe
- Equipped with automatic chemical pump, washing time and chemicals saved significantly
- Extra lubrication system
- European-standard electrical system
- Warning system with specific instructions clearly illustrated
- European-standard heating structure
- USA-standard drainage valve integrated
- Compact design for space saving
- Adopt world latest MFS suspension technology and DFW patently electric balance shock-proof technology to create better stability and durability
- Internal and external drum and flanged shaft are all made by mould without welding points, with qualified mirror finished SS304 stainless steel

- Strengthened aluminum alloy pulley with imported drive belt adopted to prolong the use life and reduce the inertia load of the motor.
- Both automatically control and manual control system.
- Variable speed control system with vector multiple-speed linear.
- Programmable water levels, temperatures and cool-down
- Safety door interlock system with large sight glass

### Installation & Maintenance

- Zero impact on the ground due to independent suspension system
- Optimized balance
- Easy maintenance for all components

### Perfect cleaning quality

- Large diameter basket with multiple ribs produces better mechanical wash action for optimum wash quality with less detergent.
- Single motor inverter drive allows programmable right wash speed for wide variety of fabrics.
- 5 automatic detergent cups turn over and flush all detergents thoroughly into the basket, no remaining lump in cups.





## CERTIFICATE

### ATTESTATION CERTIFICATE OF MACHINERY AND ELECTROMAGNETIC COMPATIBILITY AND LOW VOLTAGE DIRECTIVES

Technical file of the company mentioned below has been inspected and audit has been completed successfully.

2006/42/EC Machinery Directive 2014/30/EU Electromagnetic Compatibility Directive and 2014/35/EU Low Voltage Directives have been taken as references for these processes

Company Name : **Cleantech Dry Cleaning And Laundry Equipment**

Company Address : **FengCheng Industrial Park, Fengxian Dist., Shanghai City, China**

Related Directives and Annex : **2006/42/EC Machinery Directive  
2014/35/EU Low Voltage Directive  
2014/30/EU Electromagnetic Compatibility Directive**

Related Standards : **EN ISO 12100:2010;EN 60204-1:2006+AC:2010  
61000-6-1:2007;61000-6-3:2007+A1:2011+AC:2012**

Product Name : **Washer Extractor, Dry Cleaning, Dryer**

Report No and Date : **IDS/MD2018052204**

Product Brand/Model/Type : **See Annex Page**

Certificate Number : **M.2018.201.N4798**

Initial Assessment Date : **24.05.2018**

Registration Date : **25.05.2018**



Reissue Date/No : **-**

Expiry Date : **24.05.2023**

The validity of the certificate can be checked through [www.udem.com.tr](http://www.udem.com.tr). The CE mark shown on the right can only be used under the responsibility of the manufacturer with the completion of EC Declaration of Conformity for above relevant Directives. This certificate remains the property of UDEM International Certification Auditing Training Centre Industry and Trade Inc. Co. to whom it must be returned upon request. The above named firm must keep a copy of this certificate for 15 years from the registration of certificate. The certificate only covers the product(s) stated above and UDEM shall be notified in case of any changes on the product(s).

Address: Mulkent Mahallesi 2073 Sokak (Eski 93 Sokak) No:10 Çankaya - Ankara - TURKEY  
Phone: +90 0312 443 03 90 Fax: +90 0312 443 03 76  
E-mail: [info@udemul.com.tr](mailto:info@udemul.com.tr) [www.udem.com.tr](http://www.udem.com.tr)

  
 UDEM International Certification  
 Auditing Training Centre Industry  
 and Trade Inc. Co.



## CERTIFICATE

### ATTESTATION CERTIFICATE OF MACHINERY AND ELECTROMAGNETIC COMPATIBILITY AND LOW VOLTAGE DIRECTIVES

Technical file of the company mentioned below has been inspected and audit has been completed successfully.

2006/42/EC Machinery Directive 2014/30/EU Electromagnetic Compatibility Directive and 2014/35/EU Low Voltage Directives have been taken as references for these processes

Company Name : **Cleantech Dry Cleaning And Laundry Equipment**

Company Address : **FengCheng Industrial Park, Fengxian Dist., Shanghai City, China**

Related Directives and Annex : **2006/42/EC Machinery Directive  
2014/35/EU Low Voltage Directive  
2014/30/EU Electromagnetic Compatibility Directive**

Related Standards : **EN ISO 12100:2010;EN 60204-1:2006+AC:2010  
61000-6-1:2007;61000-6-3:2007+A1:2011+AC:2012**

Product Name : **Ironer, Folding, Feeding, Stacker**

Report No and Date : **IDS/MD2018052203**

Product Brand/Model/Type : **See Annex Page**

Certificate Number : **M.2018.201.N4797**

Initial Assessment Date : **24.05.2018**

Registration Date : **25.05.2018**

Reissue Date/No : **-**

Expiry Date : **24.05.2023**

The validity of the certificate can be checked through [www.udem.com.tr](http://www.udem.com.tr). The CE mark shown on the right can only be used under the responsibility of the manufacturer with the completion of EC Declaration of Conformity for above relevant Directives. This certificate remains the property of UDEM International Certification Auditing Training Centre Industry and Trade Inc. Co. to whom it must be returned upon request. The above named firm must keep a copy of this certificate for 15 years from the registration of certificate. The certificate only covers the product(s) stated above and UDEM shall be notified in case of any changes on the product(s).

Address: Mulkent Mahallesi 2073 Sokak (Eski 93 Sokak) No:10 Çankaya - Ankara - TURKEY  
Phone: +90 0312 443 03 90 Fax: +90 0312 443 03 76  
E-mail: [info@udemul.com.tr](mailto:info@udemul.com.tr) [www.udem.com.tr](http://www.udem.com.tr)

  
 UDEM International Certification  
 Auditing Training Centre Industry  
 and Trade Inc. Co.





# ISO CERTIFICATE

## G-CERTI Certificate

G-CERTI hereby certifies that

**CLEANTECH**

FengCheng Industrial Park, Fengxian Dist., Shanghai City, China

Has been audited by G-CERTI and has implemented

Quality Management System

**ISO 9001:2015**

Scope of Registration

Manufacture and Sales of Industrial Washing Machine,  
Industrial Dryer, Ironer, Dry Cleaning, Folding, Feeding,  
Stacker

EA Code : 19  
Issue Date : 28 Jul. 2018  
Expiry Date : 27 Jul. 2020  
Original Date : 28 Jul. 2018  
Certification No : GK - 2787 - QC

  
Chief Executive



To verify the validity of this certificate please visit : [www.gcerti.com](http://www.gcerti.com)  
This is to certify that the Management Systems of this company has been found to conform to the above G-CERTI  
FI-12-03



QMS N°115 A  
EMS N°043 D



[www.gcerti.com](http://www.gcerti.com)



## G-CERTI Certificate

G-CERTI hereby certifies that

**CLEANTECH**

FengCheng Industrial Park, Fengxian Dist., Shanghai City, China

Has been audited by G-CERTI and has implemented

Environmental Management System

**ISO 14001:2015**

Scope of Registration

Manufacture and Sales of Industrial Washing Machine,  
Industrial Dryer, Ironer, Dry Cleaning, Folding, Feeding,  
Stacker

EA Code : 19  
Issue Date : 28 Jul. 2018  
Expiry Date : 27 Jul. 2020  
Original Date : 28 Jul. 2018  
Certification No : GK - 2787 - EC

  
Chief Executive



To verify the validity of this certificate please visit : [www.gcerti.com](http://www.gcerti.com)  
This is to certify that the Management Systems of this company has been found to conform to the above G-CERTI  
FI-12-03



QMS N°115 A  
EMS N°043 D



[www.gcerti.com](http://www.gcerti.com)



# HIGH-SPEED SOFT-MOUNT WASHER EXTRACTOR

## STAINLESS STEEL CONSTRUCTION

- All metallic parts that come into contact with wash are in AISI304.
- Durable AISI304 stainless steel inner and outer drums designed for constant use.
- Front, side, and top panels are all in AISI304.

## INDEPENDENT SUSPENSION SYSTEM

- With the multi directional springs system, the machine can absorb 97% of all vibrations.
- Ensure the stability when the extract speed reaches up to max. 420G.

## DRIVE SYSTEM

- Specially made inverter, the inverter controlled motor and the matched controller programs enable the extract speed reach up to 420G.
- Advanced electronic balancing technique achieves out of balance automated load adjustment.
- Significant reduction in noise, vibration, and fatigue of the washing machine components.

Model		Unit	TNE/S-15	TNE/S-25	TNE/S-40	TNE/S-60	TNE/S-80	TNE/S-100	TNE/S-120
Capacity		kg	15	25	40	60	80	100	120
G-force		G	250-300	280-320	280-320	300-350	300-350	320-420	320-420
Drum	Diameter	mm	660	779	905	1080	1080	1310	1310
	Depth	mm	436	539	626	620	820	750	818
	Volume	Litre	149	256	402	568	750	1010	1102
Speed	Wash	rpm	35-45	35-45	35-45	35-45	35-45	30-42	30-42
	Extract	rpm	650-820	650-820	650-820	600-780	600-780	550-760	550-760
Consumption	Water	lt	190-210	320-360	500-560	750-850	1000-1120	1300-1440	1450-1600
	Electric	Kw	3.5-4	7-8	12.5-14	13.5-15	17-19	5.5-6	6-6.5
	Steam	kg	8-10	13-15	22-25	35-40	50-55	60-70	70-85
	Gas	Kcal							
Power	Supply	V/P/Hz	380V/3P /50Hz	380V/3P /50 Hz	380V/3P /50Hz	380V/3P /50Hz	380V/3P/ 50Hz	380V/3P/ 50Hz	380V/3P/ 50Hz
	Motor	Kwh	1.5	2.2	4	5.5	7.5	11	11
	Heater	Kwh	6	12	24	24	30	-	-
Dimensions	Width	mm	880	1038	1230	1620	1620	1770	1770
	Depth	mm	858	1155	1370	1500	1705	1795	1865
	Height	mm	1420	1470	1740	1970	1970	2060	2060
Weight		kg	360	720	1200	2000	2620	3000	3300

Cleantech reserves the change of machine specifications due to technological needs without prior notice

# HARD MOUNT WASHER EXTRACTOR



- Industrial rigid mount Structure
- Energy saving DC motor Technology
- High G Force of 250G
- Four compartment detergent box
- Unique dimpled and perforated drum
- Additional 3/4" Water Inlet Valve
- High-quality parts
- High contrast graphic LCD Screen

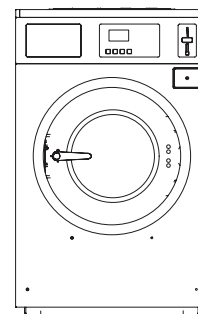

Front View

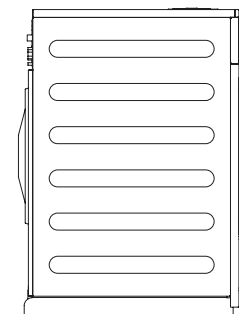

Side View

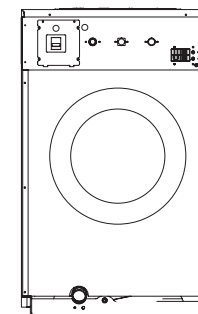

Back View

Model		Unit	TO-SXT-100G	TO-SXT-150G	TO-SXT-200G	TO-SXT-300G
Capacity		kg	10	15	20	30
G-force		G	150-200	150-200	150-200	150-200
Drum	Diameter	mm	610	610	685	774
	Depth	mm	310	438	504	600
	Volume	Liter	90	128	186	282
Speed	Wash	rpm	35-50	35-50	35-50	35-50
	Extract	rpm	500-700	450-650	400-600	400-600
Consumption	Water	lt	120-140	170-200	250-280	380-420
	Electric	Kw	0.2	0.2	5.5-6.2	7.5-8.5
	Steam	kg	-	-	-	-
	Gas	Kcal	-	-	-	-
Power	Supply	V/P/Hz	380V/3P/50Hz	380V/3P/50Hz	380V/3P/50Hz	380V/3P/50Hz
	Motor	Kwh	0.37	0.37	1.5	2.2
	Heater	Kwh	-	-	11	15
Dimensions	Width	mm	736	736	812	955
	Depth	mm	815	946	1050	1210
	Height	mm	1170	1170	1260	1430
Weight		kg	310	330	360	660

Cleantech reserves the change of machine specifications due to technological needs without prior notice

# STACKER ALL IN ONE

- Fully automatic 3 in 1 laundry machine, developed for industrial use, the unit is a combination of washer, extractor and dryer in the same machine.
- Washer and the dryer works separately controlled by two controllers. Dryer and washer extractor can work at the same time.
- Axial air flow structure achieves energy saving and higher drying efficiency.
- SS304 for both washer basket and dryer basket
- Variable frequency drive for both washer and dryer. The rotate speed of washer extractor is controlled by HOLIP inverter. It saves 40% drive consumption than traditional washer extractors.

Model		Unit	TO-SXTH-130FDQ
Capacity		kg	13
G-force		G	325
Drum	Diameter	mm	580   775
	Depth	mm	415   555
	Volume	Liter	110   260
Speed	Dry	rpm	35-50
	Extract	rpm	500-1000
Consumption	Water	lt	150-180
	Electric	Kw	5.0-7.0
	Steam	kg	-
	Gas	Kcal	-
Power	Supply	V/P/Hz	380V/3P/50Hz
	Motor	Kwh	0.37
	Heater	Kwh	5   7.5
Dimensions	Width	mm	840
	Depth	mm	928
	Height	mm	2068
Weight		kg	505

Cleantech reserves the change of machine specifications due to technological needs without prior notice



# DRY CLEANING MULTI SOLVENT



- Full automatic computer control system with manual control. Programmable computer with self-diagnostics function. Big LCD display screen. Intelligent operation.
- High standard production line ensures stronger parts and makes the part replacement easier.
- Completed stainless steel structure for all the components contacting with solvent
- A world advanced air channel structure ensures high air flow and faster recycles speed, to save drying time
- Double filtration system consists of one ecological filter and one newly designed and patented active carbon filter which doesn't need to be cleaned with dry cleaning filtration powder and carbon powder. It achieves free maintenance for filter, high cleanness, and less running cost.
- Equipped with various safety protection devices, such as pneumatic safety door lock device for loading door, lint collector, still tank residual solvent drainage door, and button trap.
- European standard solvent leak-proof tank prevents solvent leaking to contaminate the laundry and underground water, and meanwhile it can recycle the solvent.

Model		Unit	TO-P-160FDQ	TO-P-186FDQII	TO-HMS-218
Capacity		kg	8	10	12
Drum	Diameter	mm	695	686	775
	Depth	mm	450	504	468
	Tank	lt	75/75/110	125/125/160	155/155/200
Speed	Wash	rpm	35-45	35-40	35-40
	Extract	rpm	450-650	400-600	350-460
Consumption	Chemical	type	Perc	Perc	Multi
	Electric	Kw	6-8	8-10	15-20
	Time	min/cycle	30-40	40-60	40-60
Power	Supply	V/P/Hz	380V/3P/50Hz	380V/3P/50Hz	380V/3P/50Hz
	Driving motor	Kwh	1.5	1.5	1.5
	Fan motor	Kwh	0.75	1.5	1.5
	Filter motor	Kwh	0.12	0.55	0.55
	Refrigerator	Kwh	1.5	2.1	2.6
	Drying heating	Kwh	6.6	7.8	8.4
Dimensions	Width	m m	1556	1980	2110
	Depth	m m	1185	1325	1550
	Height	m m	2000	2090	2100
Weight		kg	980	1050	1250

Cleantech reserves the change of machine specifications due to technological needs without prior notice



# TUMBLE DRYERS

## ENERGY EFFICIENT

### Drum design and finish

Stainless steel material  
Finest finishing on the surface  
Perfect 4mm perforation on the drum  
Forward and reverse while running

### Extra-large door with full view tempered glass

Big diameter 1007mm  
180 degrees opening  
Stop running while door opens



### Super-Efficient Heater

Stainless steel 316L material  
Anti-rust, anti-corrosion, longer lifetime, faster heating speed  
Two groups of heating system, double the drying efficiency

### User friendly controller

The controller is specially designed for the control of the automatic dryer.  
It features stability and reliability in operation.  
The controller has very convenient human-machine interaction interface with liquid crystal display to show state of operation of the machine including temperatures at Led display and thus helps monitoring effect.  
20 different cycles can be programmed and upon a single touch of the [Start] key, the machine will run automatically to the end of the selected cycle

### Rear hood

Fully enclosed design on the rear part, avoiding dust enter into the drum, and lower the noise.  
Make the machine more beautiful and neat on the back.  
Ensure the safety due to the pulley and belts are all covered.

Model		Unit	TSE/S/G-15	TSE/S/G-25	TSE/S/G-35	TSE/S/G-50	TSE/S/G-100
Capacity		kg	15	25	35	50	100
Drum	Diameter	mm	843	958	958	1139	1452
	Depth	mm	512	775	977	958	1185
	Volume	Liter	285	550	690	970	1920
Consumption	Water	lt	-	-	-	-	-
	Electric	Kw	5.5-6	10-13	15-18	18-22	2-2.5
	Steam	kg	16-20	30-35	40-45	55-65	100-130
	Gas	Kcal					
Power	Supply	V/P/Hz	380V/3P/50Hz	380V/3P/50Hz	380V/3P/50Hz	380V/3P/50Hz	380V/3P/50Hz
	Motor	Kwh	0.37	1.1	1.1	1.5	3
	Fan motor	Kwh	0.37	1.1	1.1	1.1	2.2
	Heater	Kwh	10	25	30	40	-
Dimensions	Width	mm	925	1046	1046	1340	1652
	Depth	mm	873	1168	1476	1658	1883
	Height	mm	1835	1915	1915	2100	2438
Weight		kg	310	440	550	690	1090

Cleantech reserves the change of machine specifications due to technological needs without prior notice

# COMMERCIAL FLATWORK IRONER



Model		Unit	T0-Y-3000IE/S/G	T0-Y-3000IIE/S/G	T0-Y-3000IIIE/S/G	T0-Y-3000IIVE/S/G
Number of roller			1	2	3	4
Roller size	Diameter	mm	800	800	800	800
	Length	mm	3000	3000	3000	3000
Ironing speed		m/min	1-10	5-15	10-25	15-30
Ironing temperature		°C	180	180	180	180
Comsumption	Electric	Kw				
	Steam	kg	90-110	190-220	280-330	360-440
	Gas	Kcal	1000	2000	3000	4000
Power	Supply	V/P/Hz	380V/3P/50Hz	380V/3P/50Hz	380V/3P/50Hz	380V/3P/50Hz
	Motor	Kwh	1.1	1.5	2.2	2.2
	Heater	Kwh	27	54	81	108
Dimensions	Width	mm	4200	4200	4200	4200
	Depth	mm	1500	2500	3400	4400
	Height	mm	1300	1300	1300	1300
Weight		kg	1400	3400	3900	5600

- Easy upgrade upon customer's need (two rolls to three, four, five rolls) 340 circumference angle, more energy efficient.
- Simple one-piece transmission structure reduces the fault point when pressed with the gravity and spring automatically activated when tight.
- Easy maintenance of elastic tapes, ensuring the quality of iron, dislocation ironing belt, make the fabric well ironed.
- Ball float trap drainage unblocked without steam pressure difference needed, ensure the normal drainage machine.
- Machine body adopts numerical control laser processing, ensures the parallelism of after installation and runs more smoothly.

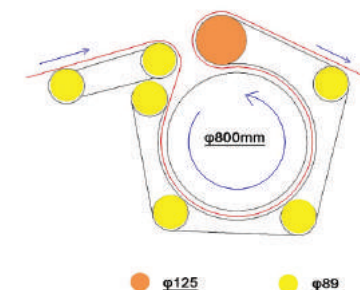

# COMMERCIAL FLATWORK IRONER



Model		Unit	TO-Y- 3300IE/S/G	TO-Y- 3300IIE/S/G	TO-Y- 3300IIIE/S/G	TO-Y- 3300IIVE/S/G
Number of roller			1	2	3	4
Roller size	Diameter	mm	800	800	800	800
	Length	mm	3300	3300	3300	3300
Ironing speed		m/min	1-10	5-15	10-25	15-30
Ironing temperature		°C	180	180	180	180
Consumption	Electric	Kw				
	Steam	kg	100-120	210-240	310-360	380-480
	Gas	Kcal	1000	2000	3000	4000
Power	Supply	V/P/Hz	380V/3P/50Hz	380V/3P/50Hz	380V/3P/50Hz	380V/3P/50Hz
	Motor	Kwh	1.1	1.5	2.2	2.2
	Heater	Kwh	27	54	81	108
Dimensions	Width	mm	4500	4500	4500	4500
	Depth	mm	1500	2500	3400	4400
	Height	mm	1300	1300	1300	1300
Weight		kg	1600	3600	4200	6000

- Easy upgrade upon customer's need (two rolls to three, four, five rolls) 340 circumference angle, more energy efficient.
- Simple one-piece transmission structure reduces the fault point when pressed with the gravity and spring automatically activated when tight.
- Easy maintenance of elastic tapes, ensuring the quality of iron, dislocation ironing belt, make the fabric well ironed.
- Ball float trap drainage unblocked without steam pressure difference needed, ensure the normal drainage machine.
- Machine body adopts numerical control laser processing, ensures the parallelism of after installation and runs more smoothly.

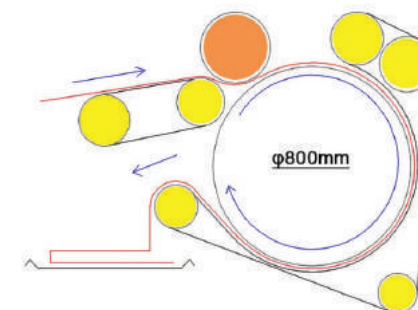

# FEEDING AUTOMATIC SHEET



Model		Unit	TO-SJ-3000	TO-SJ-3300
Max width		mm	3000	3300
Speed		m/min	50m/min	50m/min
Power	Supply	V/P/Hz	380V/3P/50Hz	380V/3P/50Hz
	Motor	Kwh	5.71	5.71
Dimensions	Width	mm	4450	4450
	Depth	mm	1200	1200
	Height	mm	1550	1550
Weight		kg	1120	1140

- Arranged in the front of the ironing machine to prevent work injuries, reduce operating costs and increase profits
- Reduce labor intensity, number of workers and manual operation cost
- High speed automatic feeding, save time, improve work efficiency, increase production more than 50%
- Simultaneous suction and air feeding, tightly sucking the quilt cover to prevent failure feeding of sheets or quilt

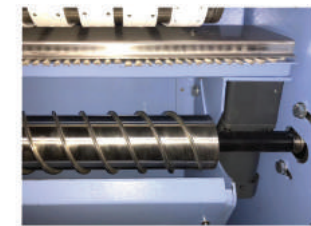

Cleantech reserves the change of machine specifications due to technological needs without prior notice



# FOLDING AUTOMATIC SHEET

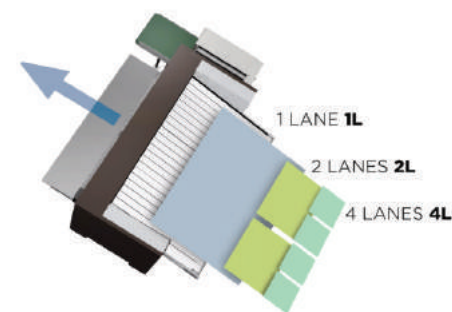

Model		Unit	TO-GD-3300
Number of lane			1 to 4
Max width		mm	3300
Speed		m/min	50
Power	Supply	V/P/Hz	380V/3P/50Hz
	Motor	Kwh	2.8
Dimensions	Width	mm	4420
	Depth	mm	2800
	Height	mm	1800
Weight		kg	1750

- Two primary fold + Three crossfolds
- Fold line up to 3300mm wide
- Automatic lane selection by size of item
- Automatically select correct number of primary folds and crossfolds by item size
- Full bypass capability to convey items through system without folding
- Push button variable speed can reach 60m/min to match feeder/ironer speed
- Advance electronics analyze size and compute folds without mechanical need
- Fold refusing function integrated if over length or over width occurs to avoid cloth jam
- Extra wide of first crossfold entrance easily adapting more linen
- First crossfold elastic roll for ease of access and maintenance
- Import clutch makes accurate stop
- Independent first crossfold drive runs only when necessary for less component wear
- Automatic alarm and stop at the first crossfold stuck linen

# STACKER AUTO-REGULATION

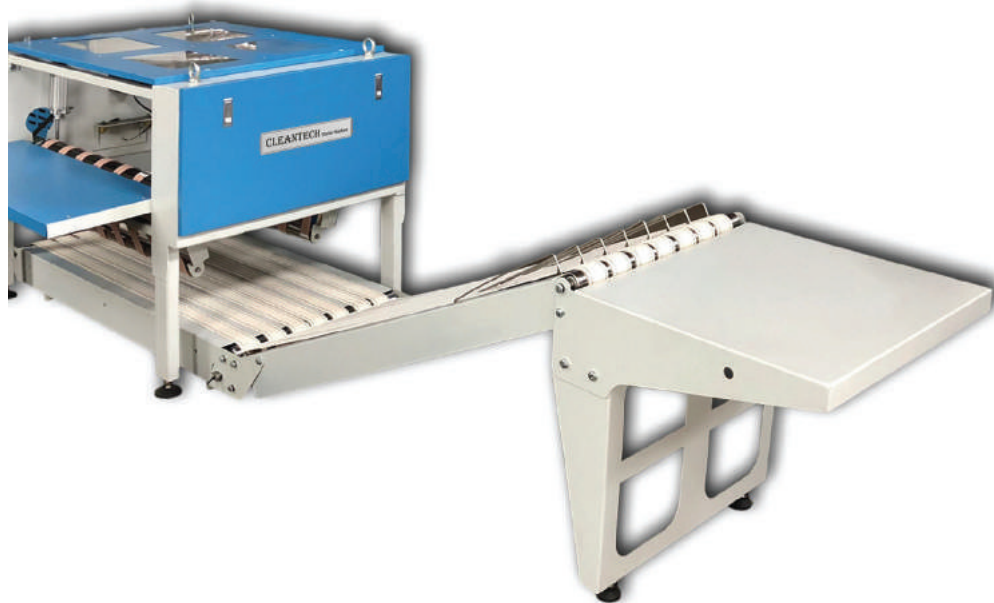

Model		Unit	TO-D-1000
Quantity of stack		pcs	1-5
Motor power		Kw	0.29
Max width		mm	1000
Air pressure		Mpa	0.55
Dimensions	Width	mm	1100
	Depth	mm	1480
	Height	mm	1000
Weight		kg	800

- Automatic regulation according to the folding discharge range.
- Adjustable stacking process, maximum stacking 20 pieces
- Combined mode set in folding machine controller

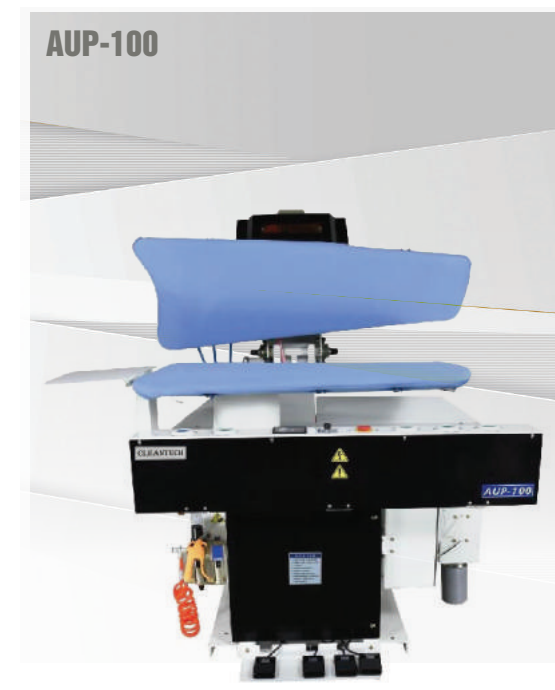

## PUFF IRON

- High efficiency
- Good quality with blowing function
- Equipped with spotting guns

## PUFF IRON

- High efficiency
- Blowing function, suitable for all kinds of clothing
- Equipped with utility to blow, spray steam and hot air, so clothes can instantly achieve a natural flat ironing effect

## UTILITY PRESS

- The suction makes it easier to fix the clothes
- Strong blast heat is suitable for none-dry clothing
- The separate upper and lower pressing panel, vapors are evenly sprayed
- The inverter helps smoothly adjust the air volume

Model	Unit	API-100	API-200	AUP-100	AFF-100	AFF-200	APM-550
Power	Kw	0.5	0.75	0.5	1	1	2
Consumption	Air	L	0.6	0.5	10	5	6
	Steam	kg	20	20	10	12	12
Power Supply	V/Hz	220V/50Hz	220V/50Hz	220V/50Hz	220V/50Hz	220V/50Hz	380V/50Hz
Dimensions	Width	mm	1475	1400	1800	1135	985
	Depth	mm	655	800	980	690	910
	Height	mm	1100	1750	1270	1590	1600
Weight	kg	150	170	320	162	175	380



## FORM FINISHER

- Human body contouring mold
- Strong blast heat for none-dry clothing
- Foot pedal makes job easy
- Frequency inverter can smoothly adjust the air volume



## MULTIFUNCTION FORM FINISHER

- Human body contouring mold
- Sleeve stretching and height adjustment for a variety of clothing
- Strong heat design for wet clothes
- Foot pedal makes job easy
- Frequency inverter can smoothly adjust the air volume



## AUTO PACKING MACHINE

- Fully automatic packaging with screw conveyor
- Automatically determine length of packaging film against length of garment due to length sensing device
- Innovative design dramatically increases packaging efficiency at speed up to 550pcs/hour
- Anti-static function

Model		Unit	API-100	API-200	AUP-100	AFF-100	AFF-200	APM-550
Power		Kw	0.5	0.75	0.5	1	1	2
Consumption	Air	L	0.6	0.5	10	5	6	5.1
	Steam	kg/h	20	20	10	12	12	-
Power Supply		V/Hz	220V/50Hz	220V/50Hz	220V/50Hz	220V/50Hz	220V/50Hz	380V/50Hz
Dimensions	Width	mm	1475	1400	1800	1135	985	1260
	Depth	mm	655	800	980	690	910	1340
	Height	mm	1100	1750	1270	1590	1600	2380
Weight		kg	150	170	320	162	175	380



# LAUNDRY LAYOUT



DRY CLEANING MACHINE



PUFF IRON



PUFF IRON



UTILITY PRESS



FORM FINISHER



AUTOMATIC FOLDING MACHINE



INDUSTRIAL IRONING MACHINE



INDUSTRIAL IRONING MACHINE

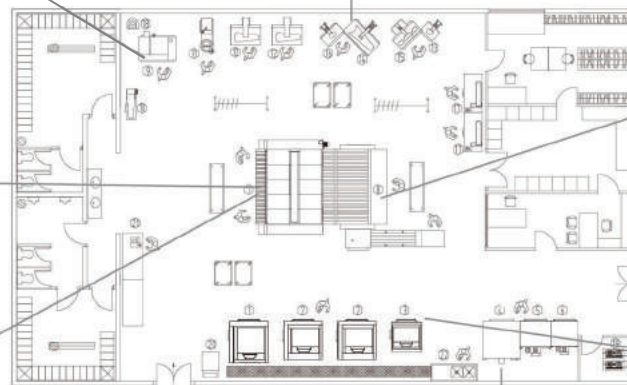

HIGH-SPEED SOFT-MOUNT  
WASHER EXTRACTOR



TUMBLE DRYERS  
MACHINE



# LAUNDRY DESIGN SOLUTIONS

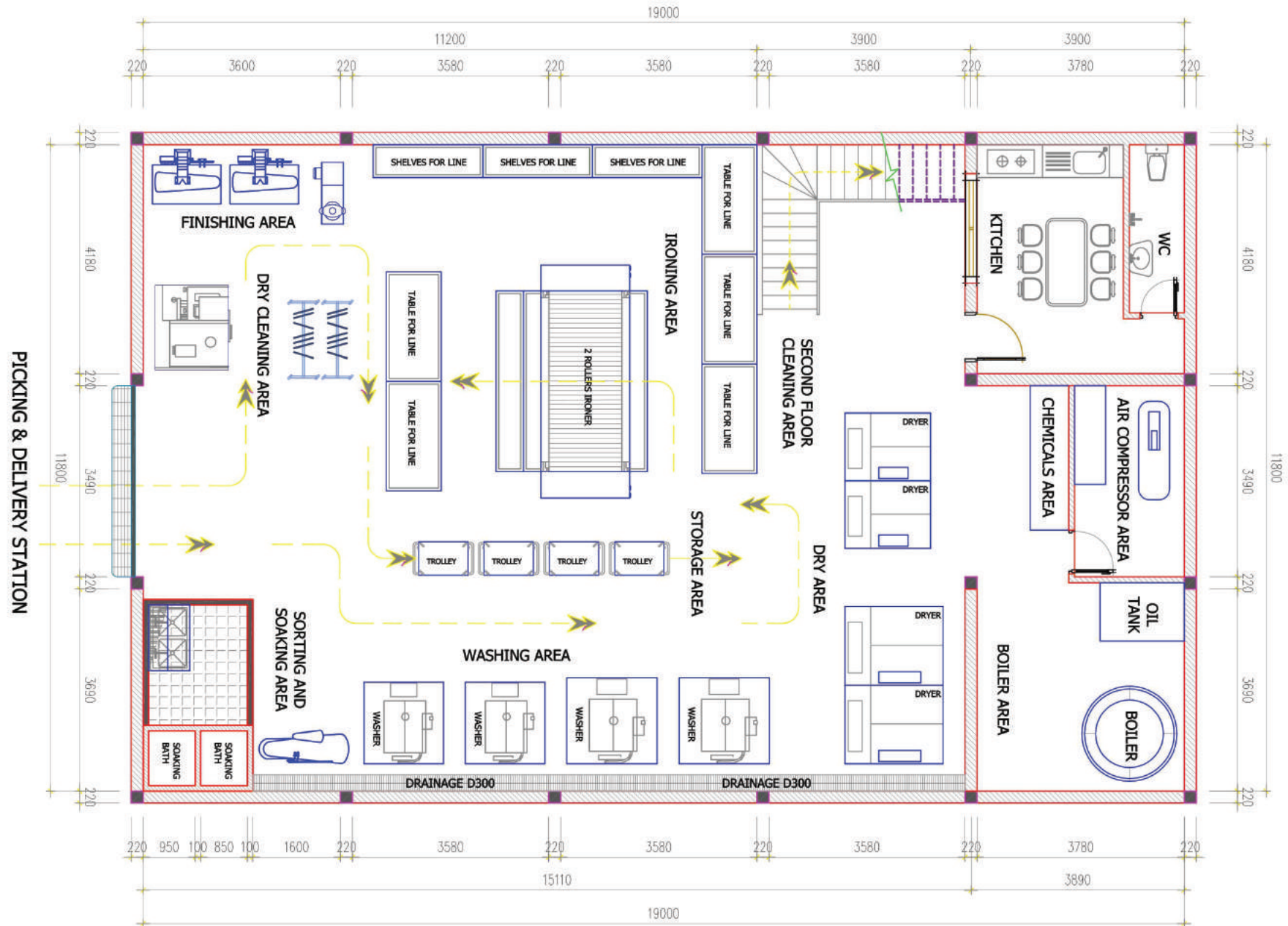

# COUNTRIES EXPORTING TO

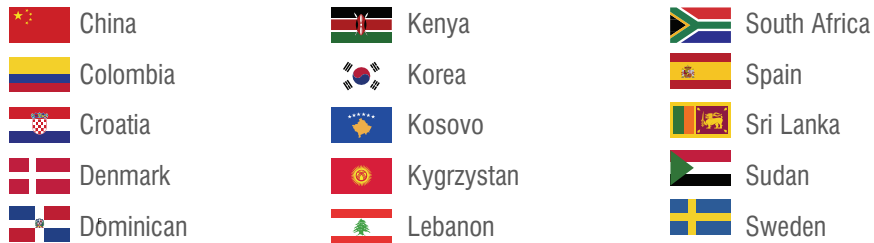





# E & B

## EASY & BEST SOLUTIONS

### EASY AND SUSTAINABLE SOLUTIONS

We propose a new way of working, aimed at achieving the best solution in the easiest way possible.

Just let us know your production requirements. We will take care of the rest.

Easy and best



## THE ONE VIETNAM JOINT STOCK COMPANY

Address: No 7, Alley 120, Tran Cung St., Nghia Tan Ward, Cau Giay Dist., Hanoi City, Vietnam

Showroom: Lot A2, CN6 Tu Liem Small and Medium Industrial Park, Minh Khai Ward, Bac Tu Liem Dist., Hanoi, Vietnam

Factory address: Feng Cheng Industrial Park, Fengxian Dist., Shanghai, China

Website: <http://theonejsc.com/> Email: [info@theonejsc.com](mailto:info@theonejsc.com) Tel: (84) 24 37 93 83 73